

# Halio® Driver Cable

The Halio Driver Cable connects the Halio window to a Halio Tint Driver, transporting the required power and data from the driver to each window to ensure optimal performance.

## SPECIFICATIONS

<b>Cable Configuration</b>	4 x 16AWG + 4 x 24AWG (twisted pairs)	
<b>Cable Jacket</b>	Black, CMP and FT6 rated	
<b>Power</b>	8A max for 4 x 16AWG power wires 0.5A max for 24AWG data wires	
<b>Withstanding Voltage</b>	300V DC	
<b>Protection Rating</b>	UL21143, Cca, CE	
<b>Connector Style</b>	Halio M12 Comm female (4+4)	
<b>Connector Diameter</b>	0.58"   14.8mm max	
<b>Cable Diameter</b>	0.315"   8mm nominal (30.01"   0.25mm)	
<b>Bend Radius</b>	1.5"   38mm minimum	
<b>Available Lengths</b>	26'   8m 49'   15m 75'   23m 150'   46m	200'   61m 249'   76m 298'   91m

## KEY FEATURES

- 4 x 16AWG power conductors provide up to 8A for fast tinting
- 4 x 24AWG (2 twisted pairs) for advanced glass monitoring
- Custom Halio multi-conductor cable based on IEC-61076-2-101 standard
- IP67-rated waterproof cable available in a variety of lengths to meet installation needs
- Industry-standard screw locking mechanism

## INSTALLATION

- Use to connect Halio glass to a Halio Tint Driver
- Female M12 connector provides screw-lock connection with male Halio glass pigtail cable
- Unterminated end allows eight individual conductors to be inserted into Tint Driver 8-position connector

# INSTALLATION

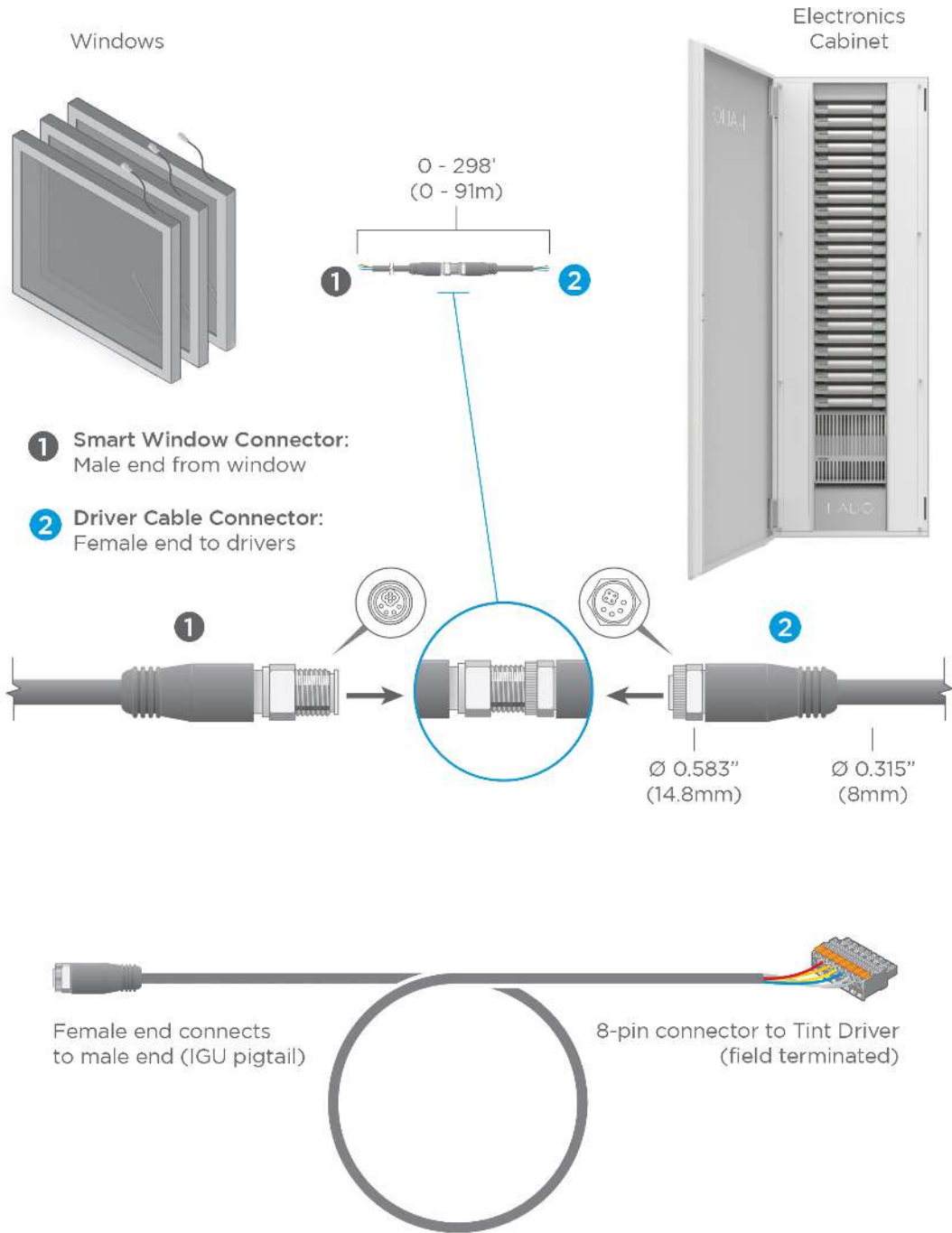

## Warranty

5 years, limited

©2020 Kinestral Technologies, Inc. Halio and Kinestral are trademarks of Kinestral Technologies, Inc. Halio North America, LLC and Halio International, S.A. are licensees of the Halio trademark and brand. All other trademarks are owned by their respective manufacturers.

HDCWv8-20200121

# HALIO

halioglass.com